



HAMNER AVENUE BRIDGE & WIDENING PROJECT



Construction Alert: Week of March 29, 2021

Daytime construction scheduled from 7 a.m. to 5 p.m., weather permitting.

Hamner Avenue: Construction continues behind k-rail north of the Hamner Avenue bridge. Crews are working on concrete removal and asphalt pavement removal.

Southwest slope:

Crews will continue excavating the embankment and will add erosion control on the southwest slope of the Santa Ana River riverbed near Hamner Avenue. Nearby residents may hear noises associated with regular construction activities such as engines running, automatic reverse backup alarm on heavy equipment and crews talking during this daytime work.

Santa Ana River riverbed: Work continues near Old Hamner Road. Pedestrians, equestrians and cyclists should use caution when traveling near Old Hamner Road as large machinery is using this area to access the riverbed.

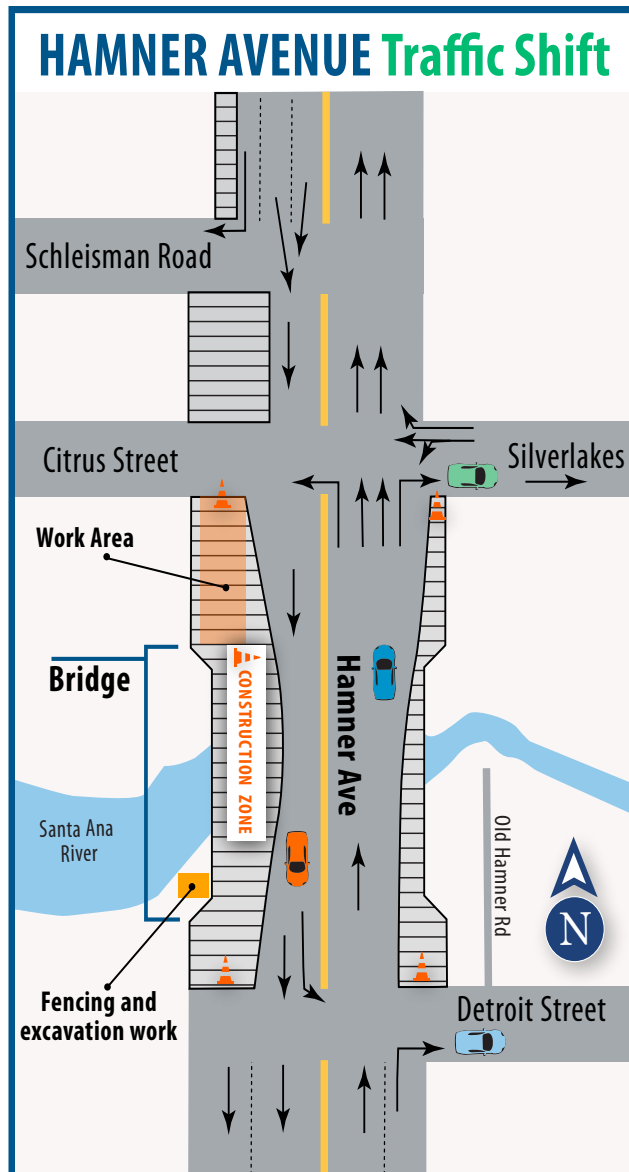

Reminder: The traffic pattern has changed on Hamner Road in the construction area. **Please do not block intersections or the entrance to the Fire Station on Hamner Avenue. Riverside County Sheriffs will be enforcing infractions.** Please allow extra time to travel through the area.

Neighboring Projects

Work on neighboring projects continues:

- City of Eastvale's paving repair and resurfacing project at Hamner Avenue and Schleisman Road (951-703-4470)

STAY CONNECTED

www.HamnerAveProject.com

877.278.7606

@HamnerAveProject



The contents of this alert are subject to change without warning due to weather or unforeseeable construction changes.

Project Partners



**CITY OF
NORCO**
HORSETOWN USA



**RIVERSIDE
COUNTY
TRANSPORTATION
COMMISSION**



CITY OF EASTVALE